

**Vero Air Furniture handrinse basin # 0724500000 / 0724500008 / 0724500009**

| < 19 5/8" Inch > |

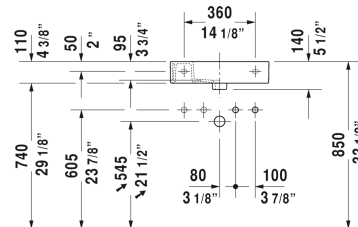
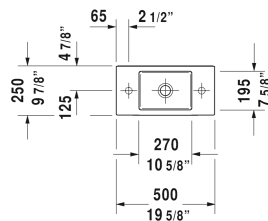

Furniture handrinse basin	Dimension	Weight	Order number
without overflow, with faucet deck, underside fully glazed, wall-mounted, 19 5/8" Inch			
<b>Colors</b>			
00 White			
<b>Variant</b>			
☒ without faucet hole	19 5/8" x 9 7/8" Inch	19.8 lb	0724500000
● faucet hole on right side	19 5/8" x 9 7/8" Inch	19.8 lb	0724500008
● faucet hole on left side	19 5/8" x 9 7/8" Inch	19.8 lb	0724500009
<b>Infobox</b>			
For vanity units the space-saving siphon is recommended			
Sanitary ceramics with the special WonderGliss surface finish will remain clean and attractive-looking for a long time to come. When ordering WonderGliss please add a "1" as eleventh digit to the model number.			
Slotted waste for washbasins without overflow	2" Inch	0.9 lb	005038
Design Siphon		3.3 lb	005036
Space-saving siphon	1 1/4" Inch	0.9 lb	005076
<b>Suitable products</b>			
Vanity unit wall-mounted 1 door, 18 7/8" x 9 1/2" Inch	18 7/8" x 9 1/2" Inch		LC6246 L/R
Vanity unit floorstanding 1 door, 1 glass shelf, 18 7/8" x 9 1/2" Inch	18 7/8" x 9 1/2" Inch		LC6751 L/R
Vanity unit wall-mounted 1 door, 19 1/8" x 9 1/2" Inch	19 1/8" x 9 1/2" Inch		BR4051 L/R
Vanity unit floorstanding 1 door, 1 glass shelf, 19 1/8" x 9 1/2" Inch	19 1/8" x 9 1/2" Inch		BR4431 L/R
Vanity unit wall-mounted 1 door, 19 1/8" x 9 1/2" Inch	19 1/8" x 9 1/2" Inch		XS4091 L/R

**Vero Air Furniture handrinse basin # 0724500000 /  
0724500008 / 0724500009**

|< 19 5/8" Inch >|

Vanity unit floorstanding 1 door, integrated legs with height adjustment, 19 1/8" x 9 1/2" Inch	19 1/8" x 9 1/2" Inch	XS4471 L/R
Vanity unit wall-mounted 1 door, for Vero Air # 072445, 17 1/8" x 13 1/4" Inch	17 1/8" x 13 1/4" Inch	XV4231 L/R
Vanity unit wall-mounted 1 door, 19 1/8" x 9 1/4" Inch	19 1/8" x 9 1/4" Inch	XV4232 L/R
Vanity unit floorstanding 1 door, 19 1/8" x 9 1/4" Inch	19 1/8" x 9 1/4" Inch	XV4532 L/R

*All drawings contain the necessary measurements which are subject to standard tolerances. They are stated in inch & mm and are non-binding. Exact measurements, in particular for customized installation scenarios, can only be taken from the finished ceramic piece.*